

DesignLine

Designline is our answer to low cost office fitouts. The slim 45mm profiles offer a refined minimalistic look without compromising the stability of the walls. Our grooved headsections allow you to easily centre your glazing or door frame after capping the wall, and our door jamb options allow for door widths of up to 50mm.

- Works with all ASL systems
- Designed for ceiling heights under 2.8m
- Includes glazing profile of 44mm x 25mm
- Includes door jambs, glazing bars and mullions
- Can be used independently or in conjunction with ASL head tracks



Standard Suite Profiles - Suitable for: 64 & 92 Steel Stud, 13mm Plasterboard incl. Glazing Profiles

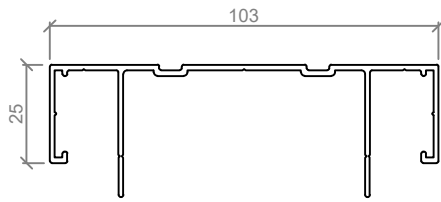

ASL 400
103mm REBATED HEADSECTION

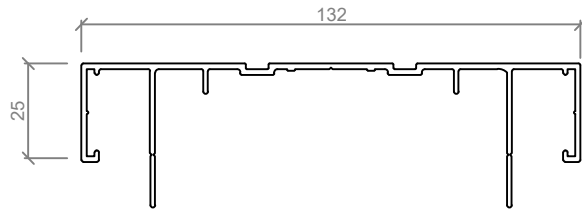

ASL 420
132mm REBATED HEADSECTION

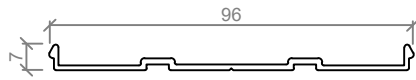

ASL 125
REBATED STARTER CAP

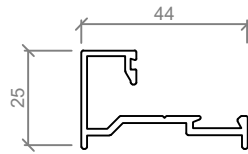

ASL 205
GLAZING BAR - STANDARD

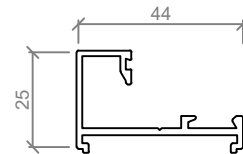

ASL 210
GLAZING BAR - LEGS

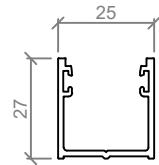

ASL 321
GLAZING CHANNEL

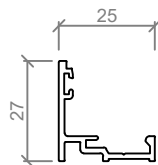

ASL 540
GLAZING BAR

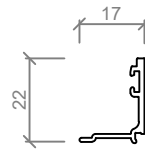

ASL 541
GLAZING BEAD

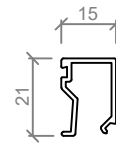

ASL 215
GLAZING BEAD

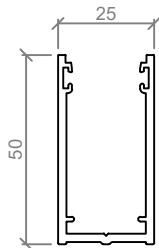

ASL 542
GLAZING CHANNEL

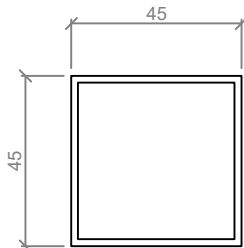

ASL 300
BOX SECTION

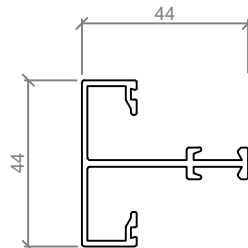

ASL 225
GLAZING MULLION

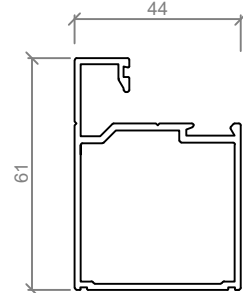

ASL 315
PILLAR POST

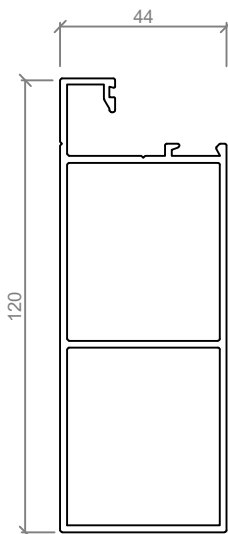

ASL 680
GLAZING BEAM

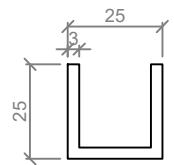

ASL 320
CHANNEL

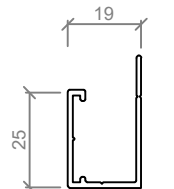

ASL 325
GIB LINING CAP



ASL 130
FLAT BAR

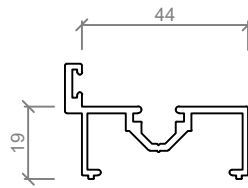

ASL 305
DOOR JAMB - 40mm

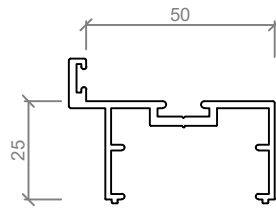

ASL 310
DOOR JAMB - 50mm

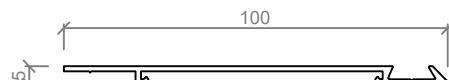

ASL 601
100mm SKIRTING

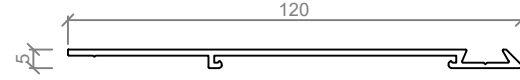

ASL 356
120mm SKIRTING

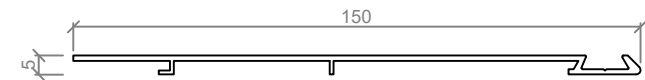

ASL 602
150mm SKIRTING

Standard Elevation

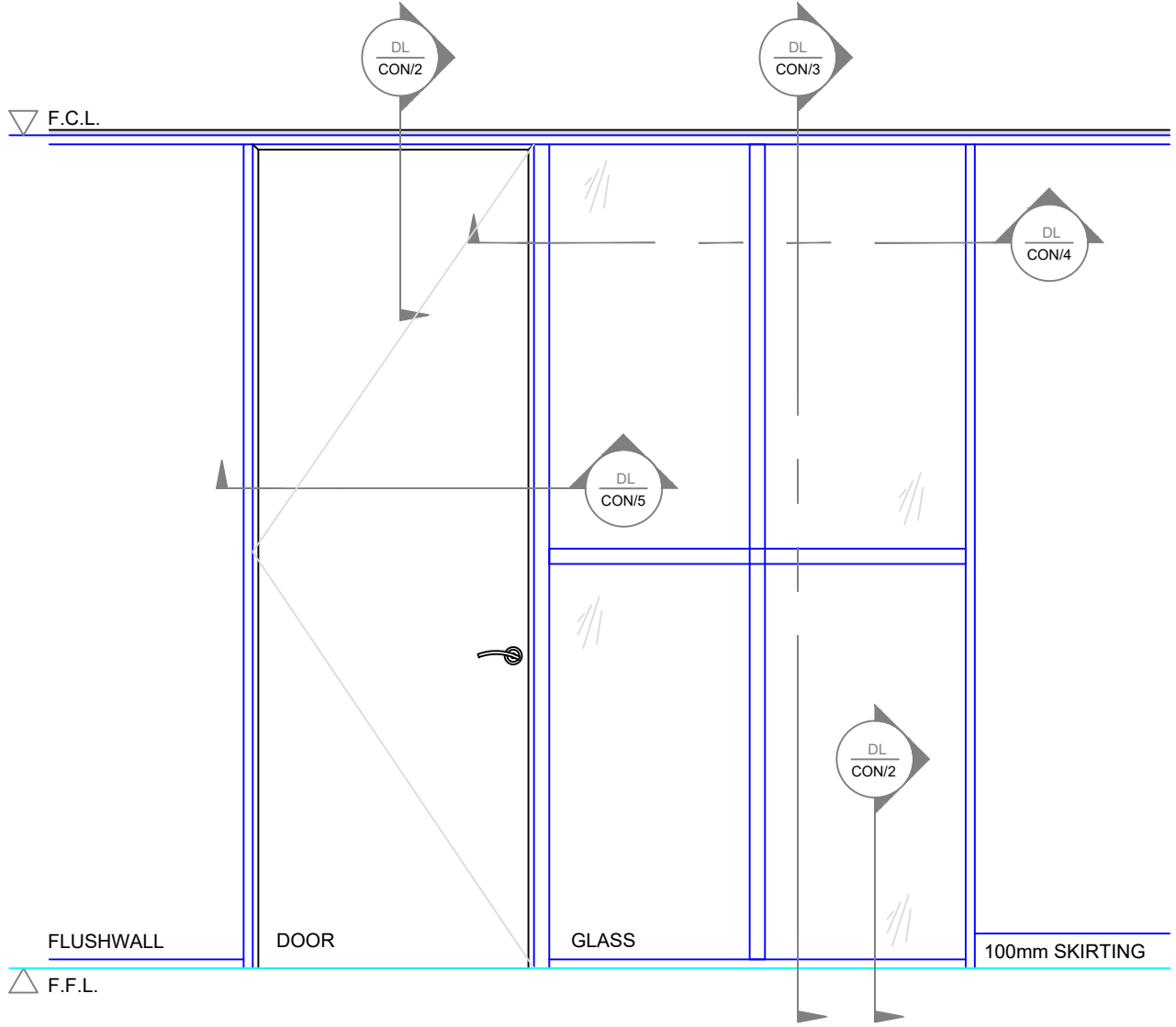

Standard Details - Full Height Glazed Wall with Transom

NOTE: WHERE SEISMIC BRACING IS REQUIRED, USE PSL 010R / 004 / 005

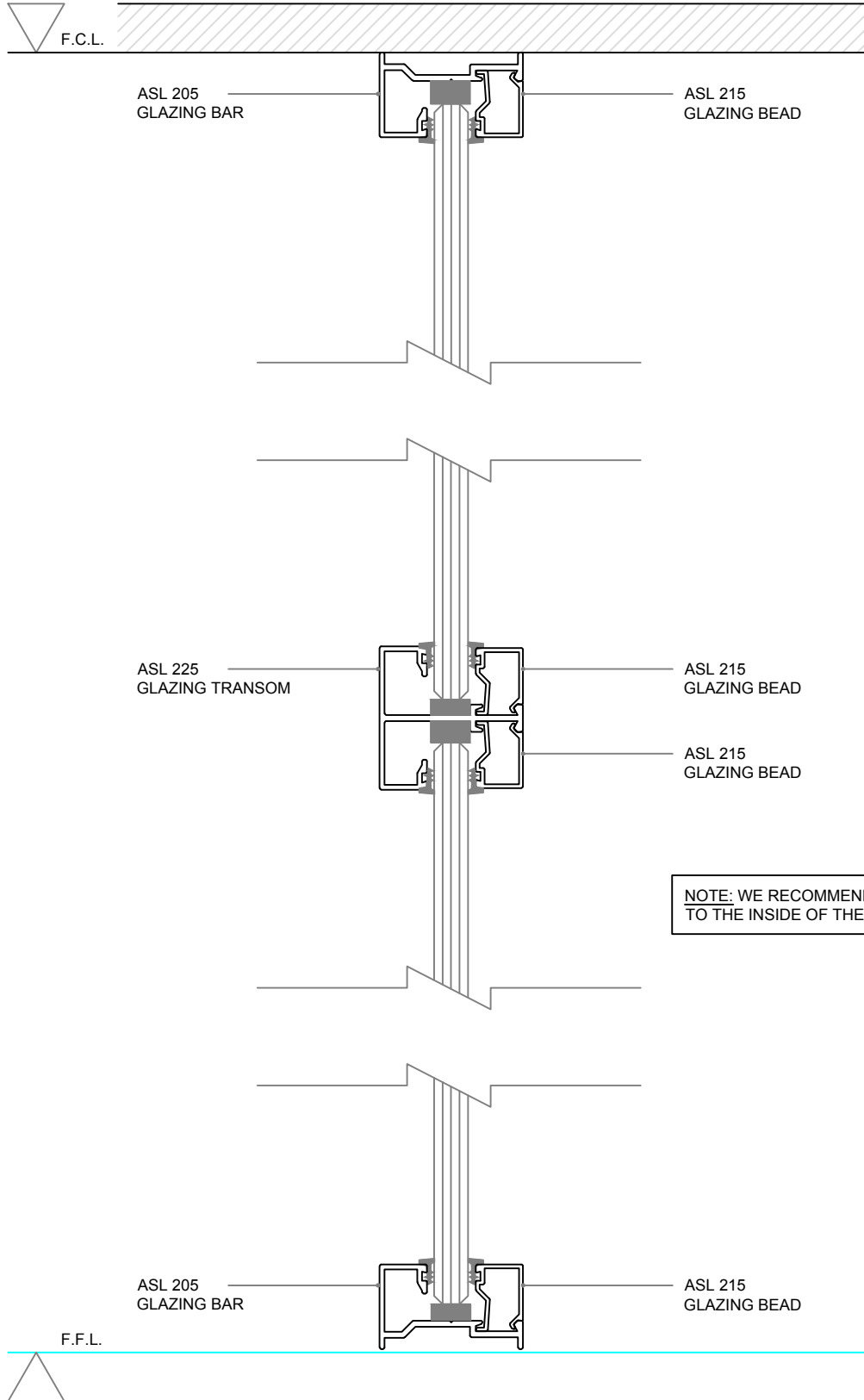

Standard Details - Glazing Channel, Glazing Bar & Bead

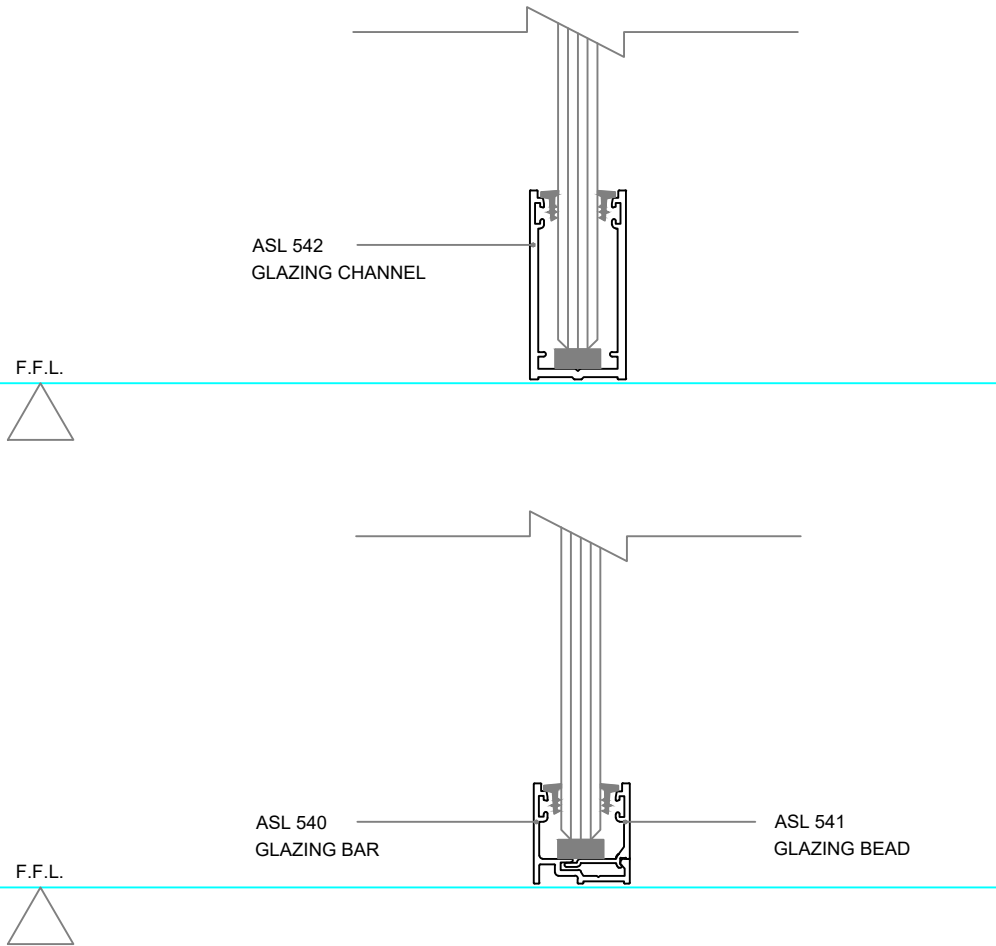

Standard Details - 64mm Steel Stud, Solid Door, Pillar Post, Glazing

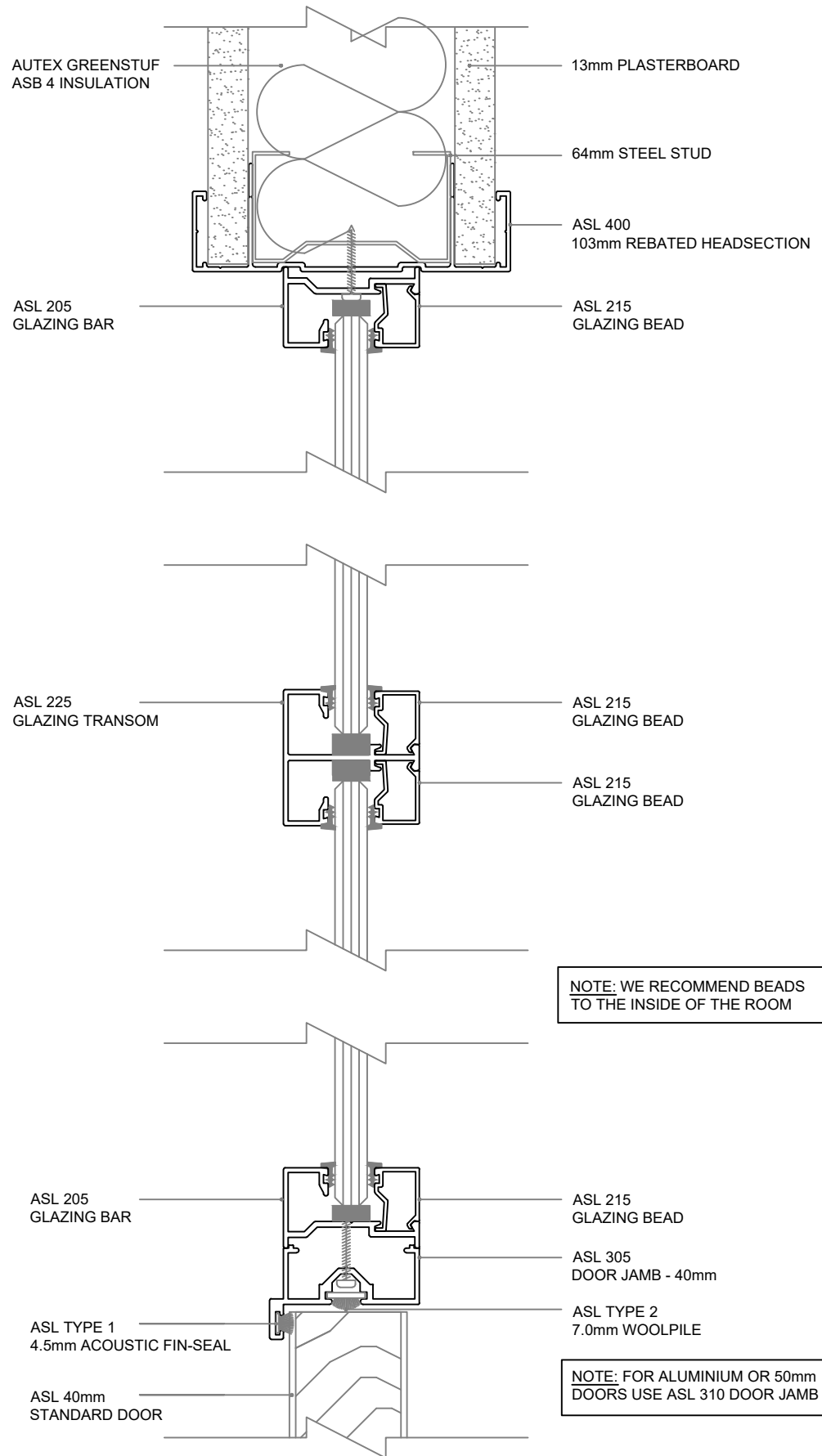

Standard Details - Solid Door with Mullion, 64mm Steel Stud

NOTE: FOR WALLS UP TO 2.8M TALL

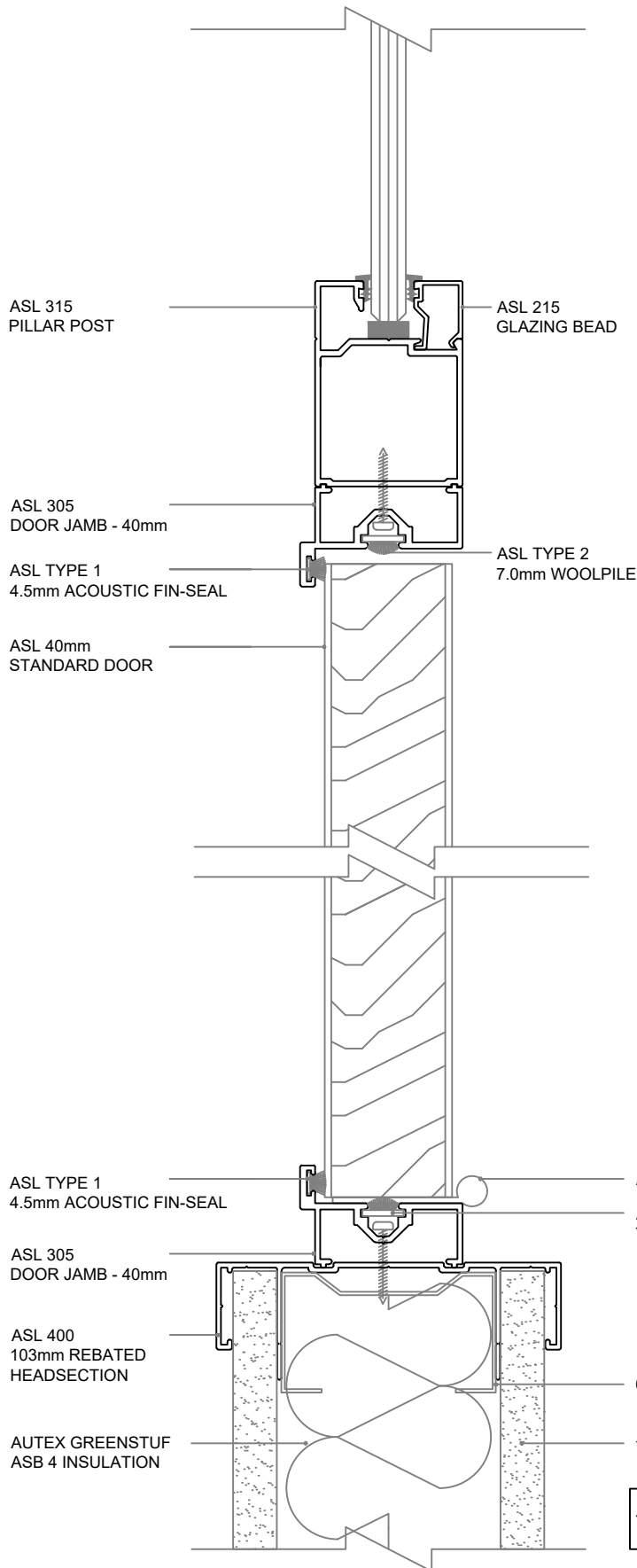

NOTE: FOR WALLS UNDER 2.3M TALL

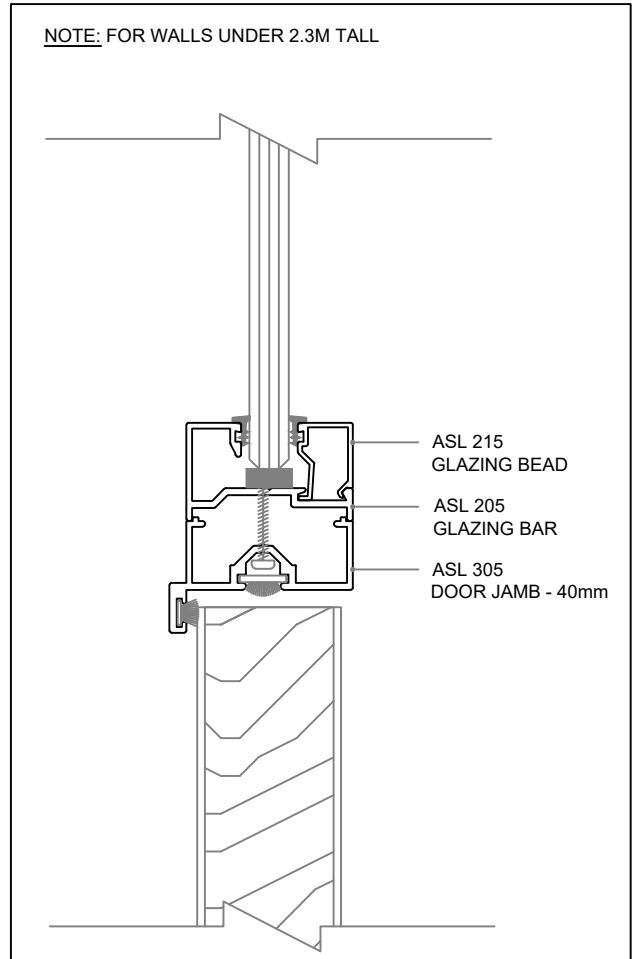

NOTE: FOR ALUMINIUM OR 50mm DOORS USE PSL DL-310 DOOR JAMB

Standard Details - Door Head

NOTE: HEAD BAR & BEAD TO COVER THE FULL OPENING

