

## 64 Series

Our 64 series accommodates a 64mm stud with a single layer of plasterboard on each side, making it the ideal system for dividing up your office space. With the wide range of profiles, you can achieve exactly the look you want, be it a negative detail, varying door thicknesses or offset glazing when in conjunction with our Acoustic & Edge ranges. Our 64 series is widely used in both commercial office fitouts, and the education sector.

- Suited to 64mm stud
- Designed for ceiling heights up to 3.2m (but not limited to)
- 103mm wide and profile heights of 25mm to 44mm
- Easily accommodates 12.38mm Laminated glass
- Built in screw ports and staking bracket locators
- Negative detail options available
- Seismic head track option available
- Range of options for mullions, transoms & door frames

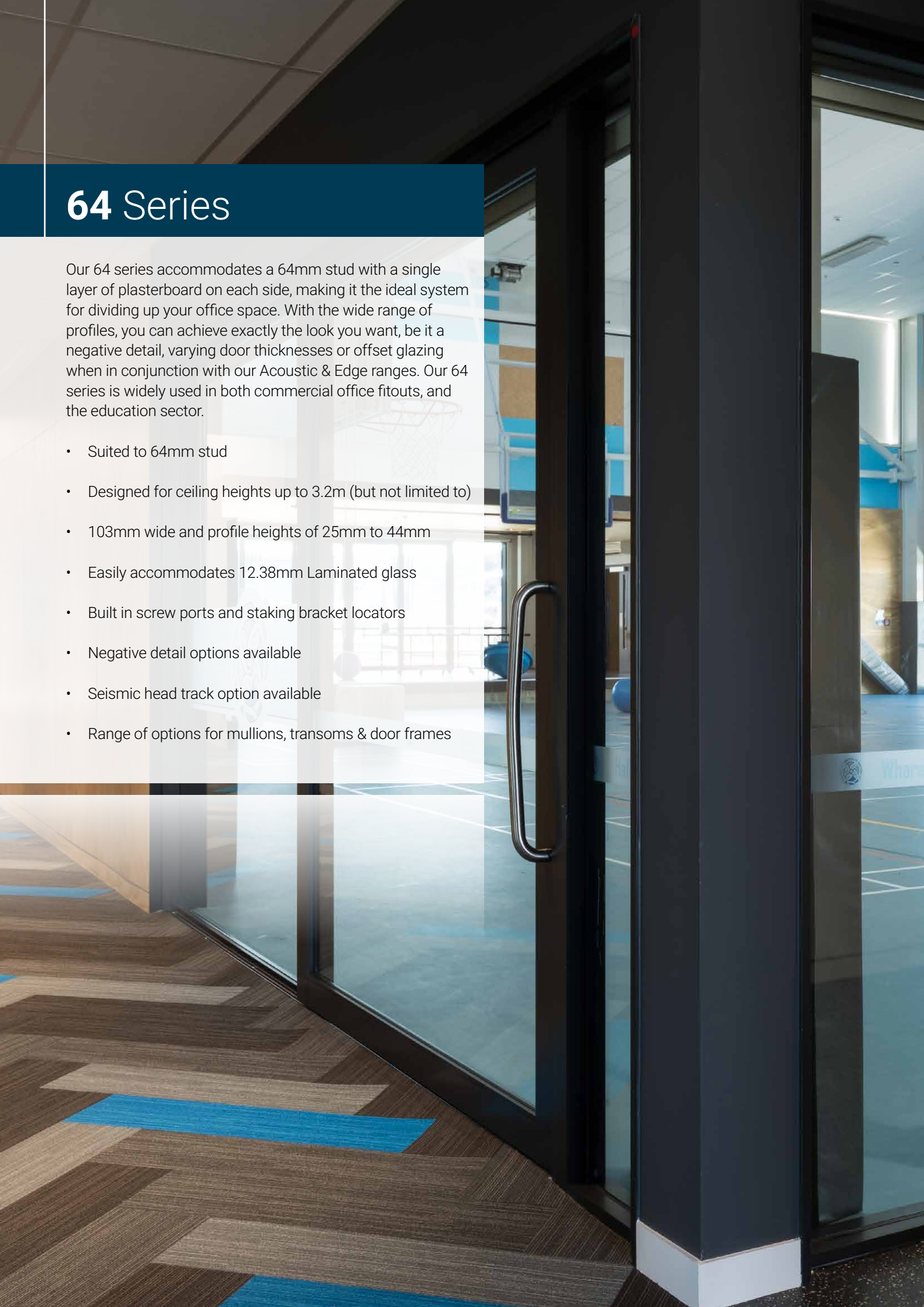

**Standard Suite Profiles** - Suitable for: 64mm Steel Stud, 13mm Plasterboard incl. Glazing Profiles

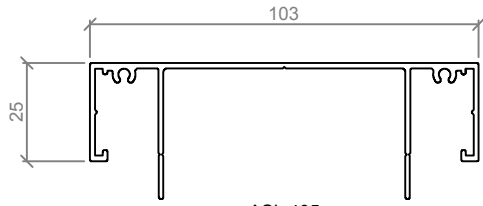

ASL 405  
103mm FLUSH HEADSECTION

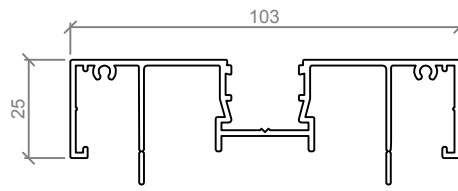

ASL 546  
103mm POCKET HEADSECTION

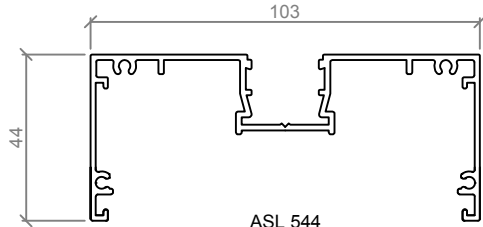

ASL 544  
103mm POCKET MULLION

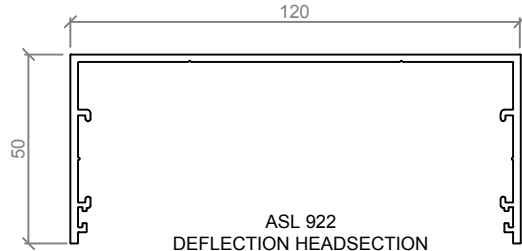

ASL 922  
DEFLECTION HEADSECTION

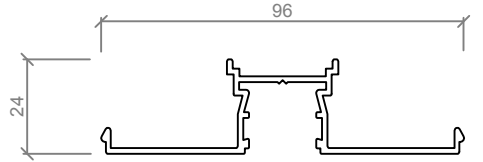

ASL 543  
POCKET STARTER CAP

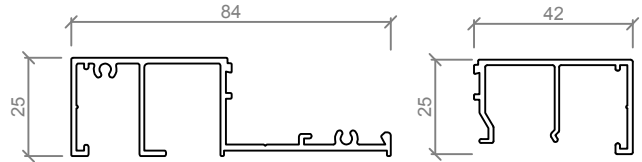

ASL 588  
GLAZING BAR

ASL 587  
GLAZING BEAD

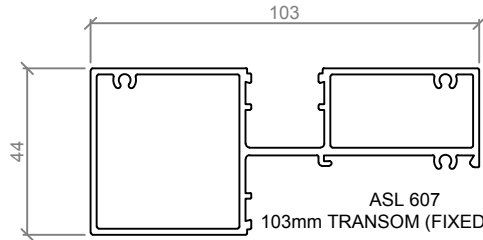

ASL 607  
103mm TRANSOM (FIXED BEAD)

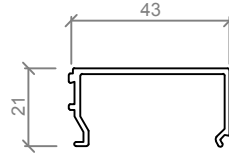

ASL 608  
TRANSOM BEAD

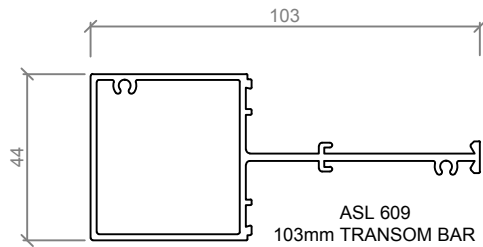

ASL 609  
103mm TRANSOM BAR

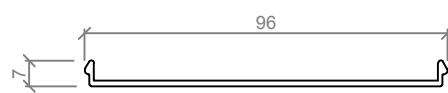

ASL 537  
FLUSH STARTER CAP

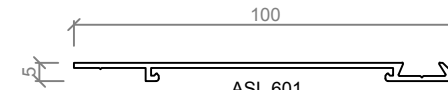

ASL 601  
100mm SKIRTING

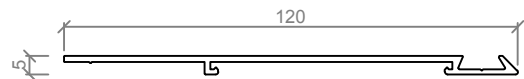

ASL 356  
120mm SKIRTING

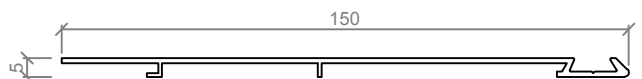

ASL 602  
150mm SKIRTING

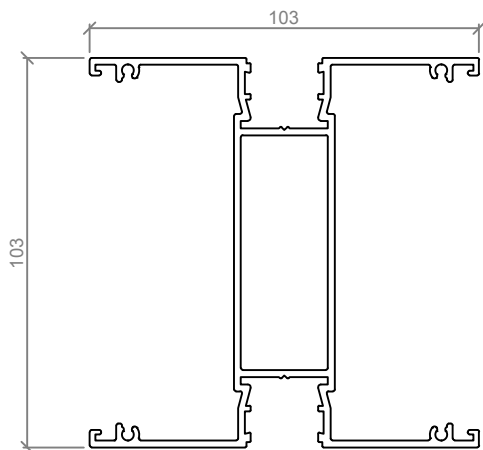

ASL 538  
103mm MULTI POST

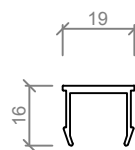

ASL 648  
POCKET FLUSH INFILL

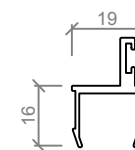

ASL 545  
POCKET DOOR STOP  
UP TO 40mm DOOR

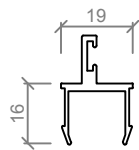

ASL 547  
POCKET DOOR STOP  
UP TO 50mm DOOR

**Negative Detail Profiles** - Suitable for: 64mm Steel Stud, 13mm Plasterboard

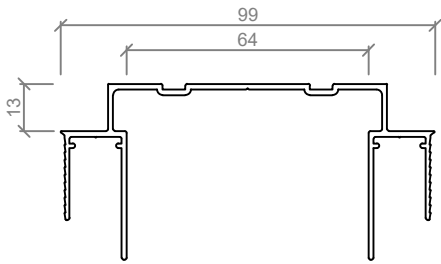

ASL 740  
GROOVED HEADSECTION (13mm NEG. DETAIL)

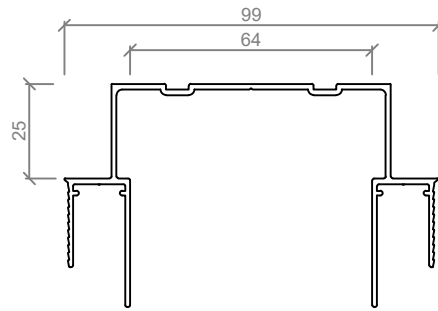

ASL 754  
GROOVED HEADSECTION (25mm NEG. DETAIL)

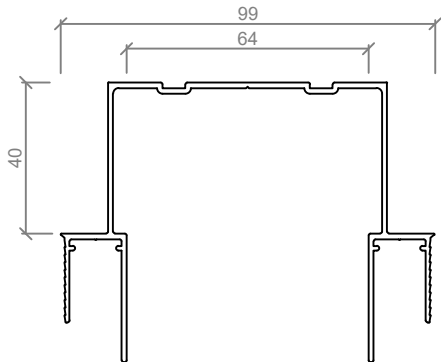

ASL 742  
GROOVED HEADSECTION (40mm NEG. DETAIL)

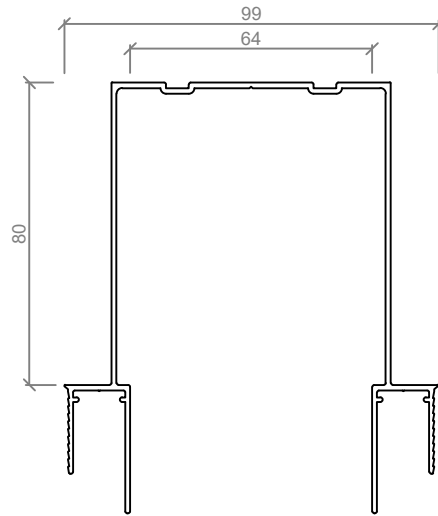

ASL 749  
GROOVED HEADSECTION (80mm NEG. DETAIL)

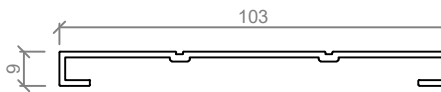

ASL 745  
FLUSH CAP (USE WITH PSL 64-740)

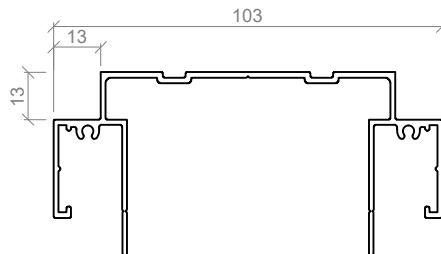

ASL 407  
103mm SHADOWLINE HEADSECTION

## Standard Elevation

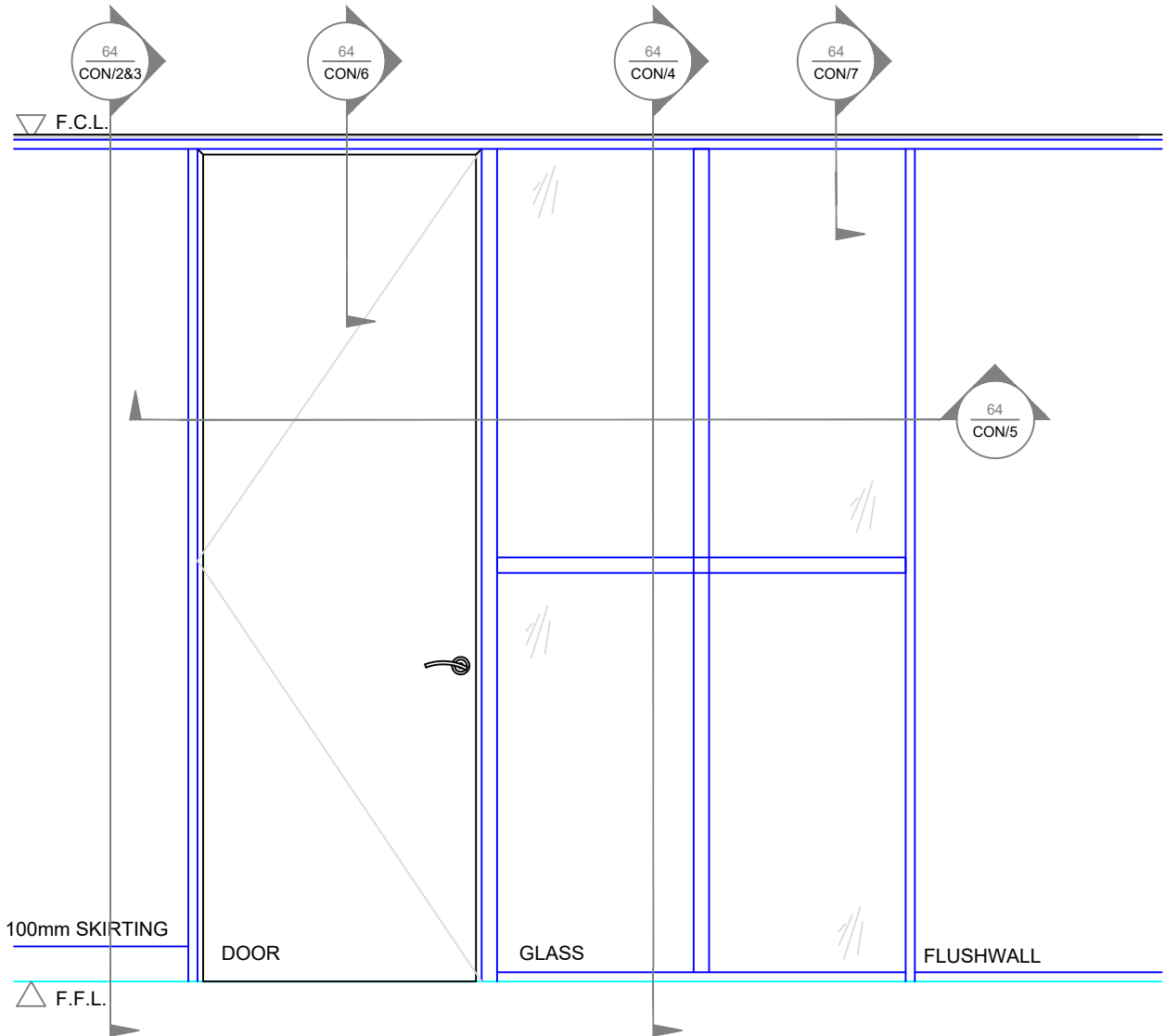

**Standard Detail - Headsection Wall - 13mm Plasterboard with Skirting**

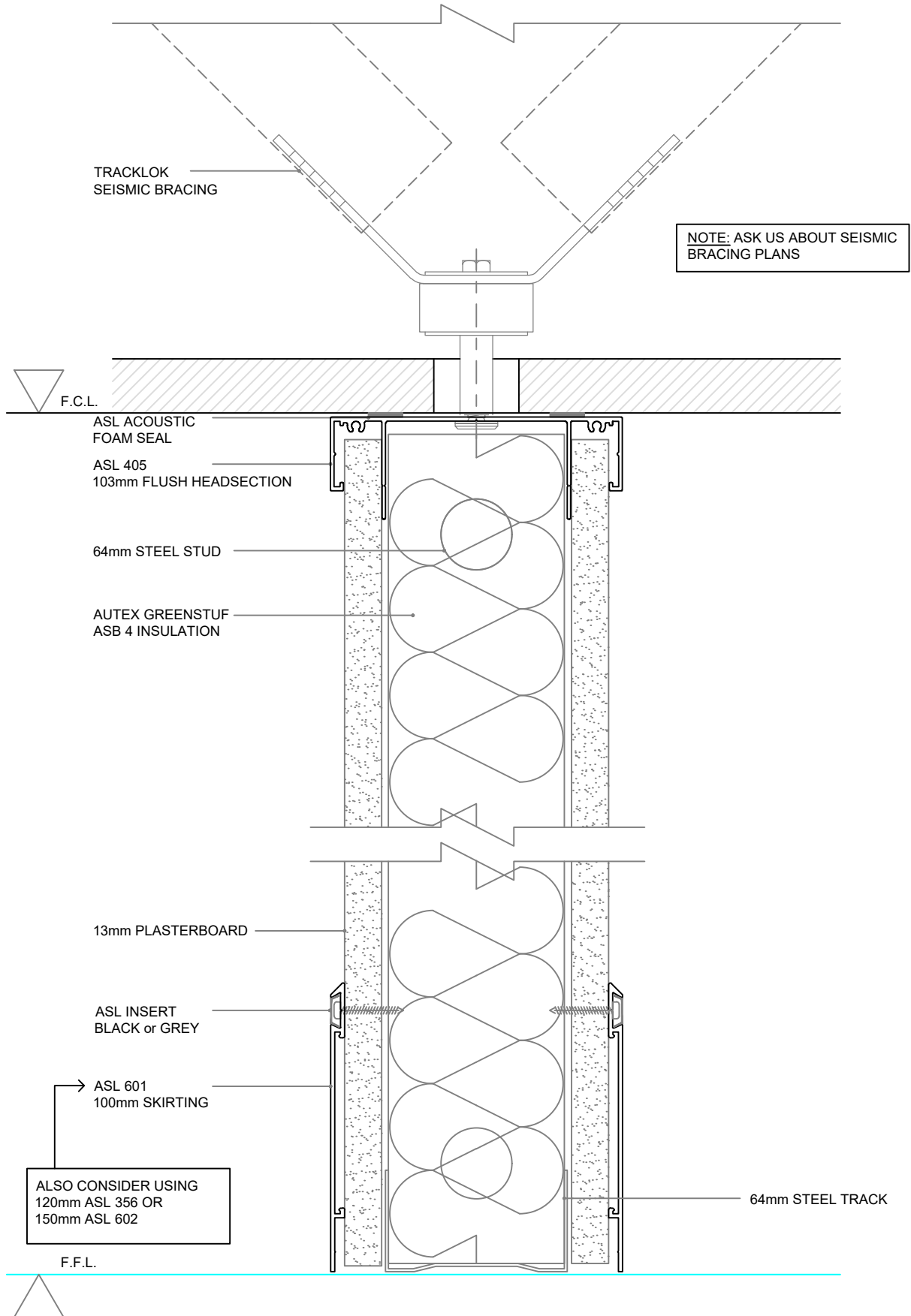

**Standard Details Negative Detail Headsection Wall - 13mm Plasterboard with negative detail**

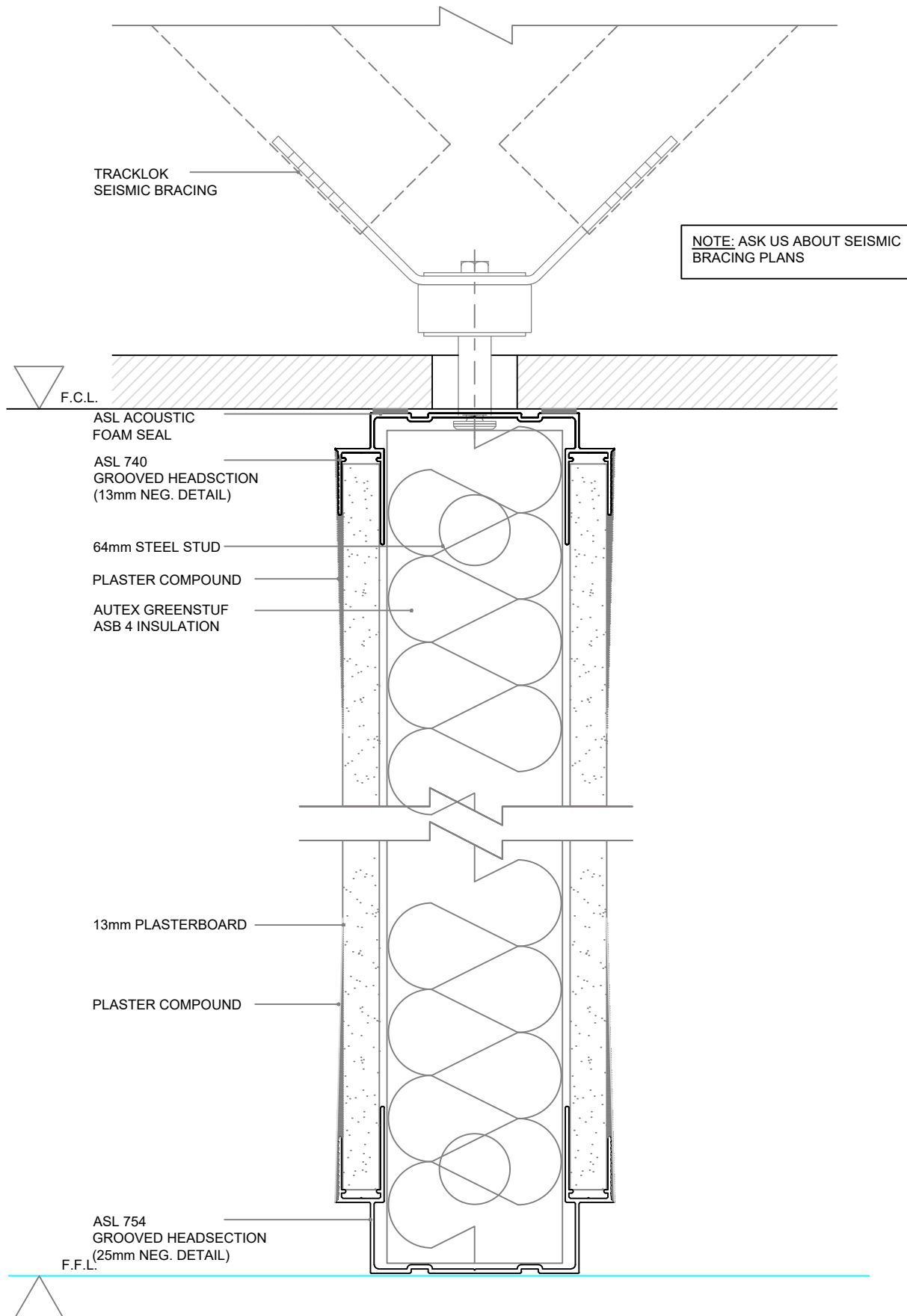

## Standard Details Glazed Vertical Wall with transom

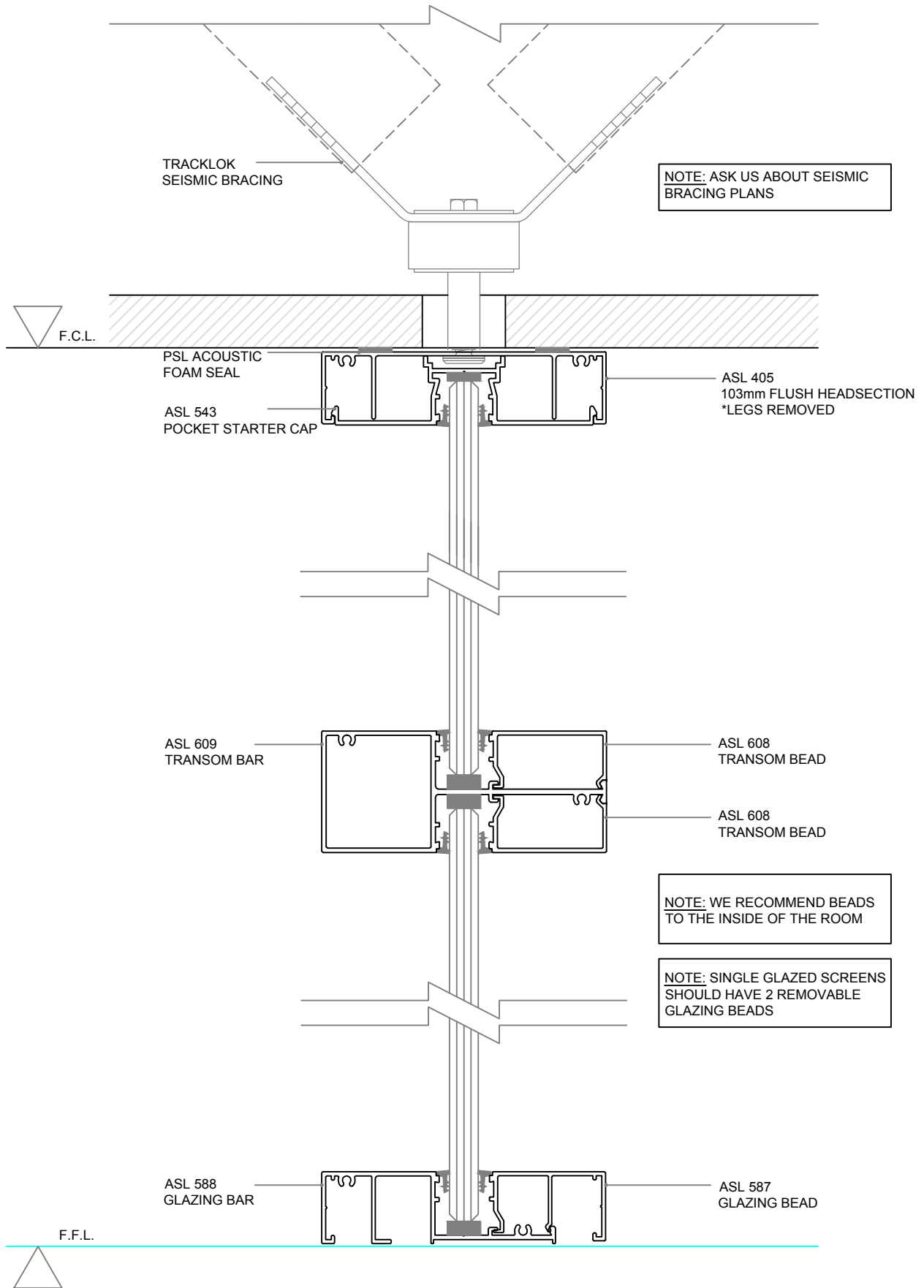

**Standard Details - 64mm Steel Stud, Glazing, Solid Door, 13mm Plasterboard**

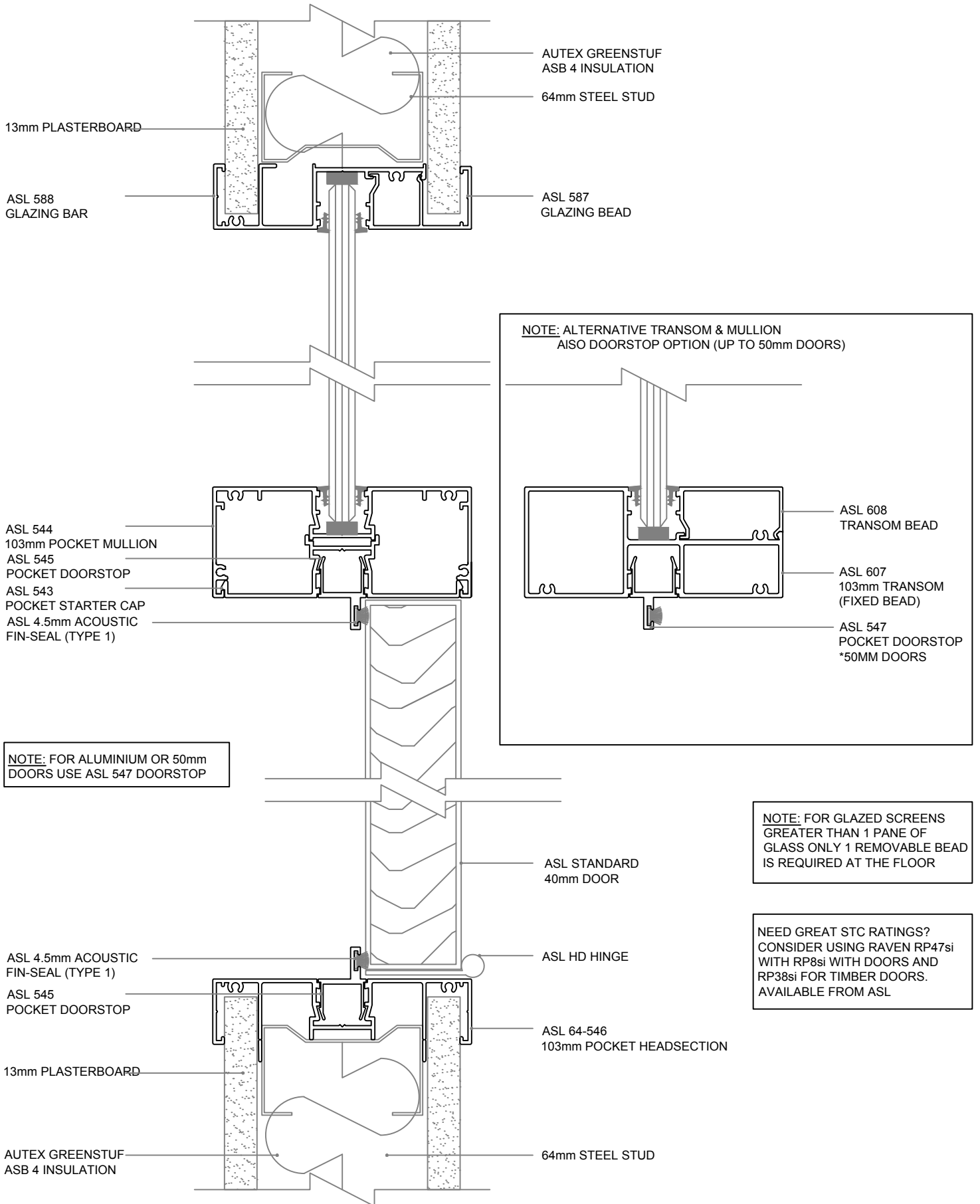



**Standard Details - Door Head, Door Jamb with Negative Detail**

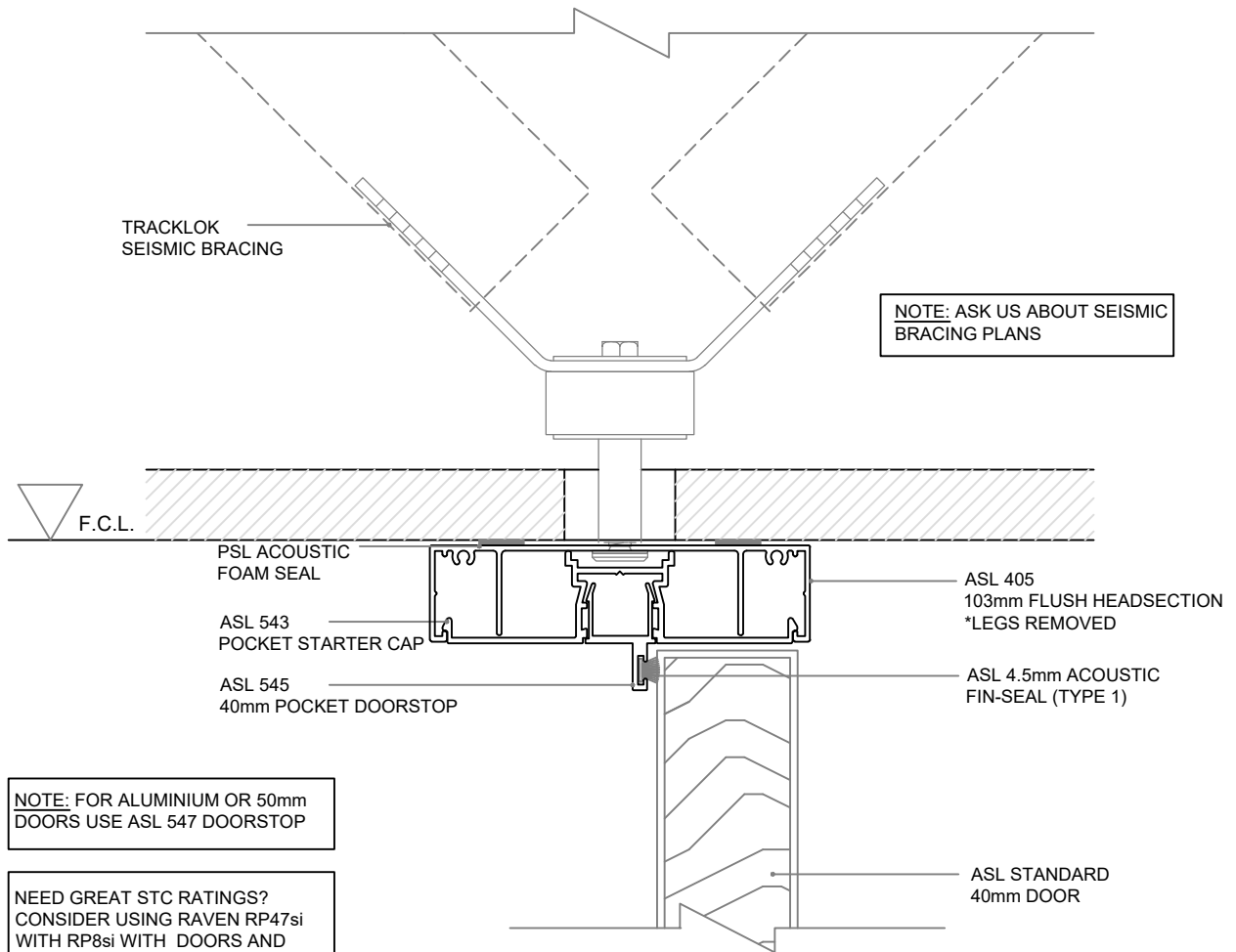

NOTE: FOR ALUMINIUM OR 50mm DOORS USE ASL 547 DOORSTOP

NEED GREAT STC RATINGS? CONSIDER USING RAVEN RP47si WITH RP8si WITH DOORS AND RP38si FOR TIMBER DOORS. AVAILABLE FROM ASL

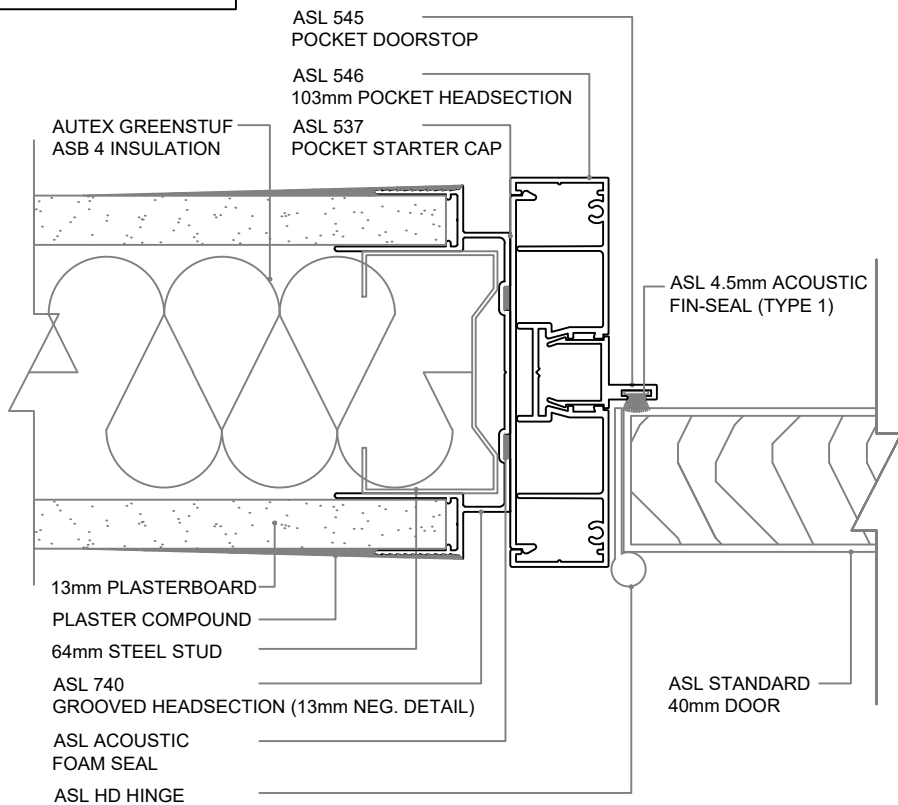

**Standard Details - Deflection Headsection above Glazed Wall**

